



Republic of the Philippines
SOUTHERN LEYTE STATE UNIVERSITY
 Main Campus, Sogod, Southern Leyte
 website: www.slsuonline.edu.ph
 email: slsumaincampus@gmail.com/
 op@slsuonline.edu.ph telefax: (053) 577-8299



Bids & Awards Committee

SUPPLEMENTAL/BID BULLETIN No. 02

This Addendum No. 02 is issued to modify or amend items in the Bid Documents. This shall form an integral part of the Bid Documents.

1-LOT SUPPLY, DELIVERY & INSTALLATION OF AIR-CONDITIONING UNITS FOR THE UNIVERSITY LIBRARY (PB 2021-G&S-07)

Technical Specifications	
From:	To:
➤ 5TR Floor Mounted Aircon Energy Efficient Ratio:	5TR Floor Mounted Inverter Aircon Energy Efficient Ratio: 63,300 KJ/Hr
NOTE: SLSU Main Campus has 3-Phase Electrical System	
Warranty	
➤ 2 years warranty for parts and service	1 year warranty on parts and services (services refers to services rendered during replacement of parts while under warranty)
Layout	Please see attachment
Paper Size for Bidding Documents	A4 size
Marking & Sealing of Bid Documents	
	<p>Original Documents: <i>Technical – 1 envelope</i> } <i>1 envelope</i></p> <p><i>Financial – 1 envelope</i> }</p> <p>Duplicate: <i>Technical – 1 envelope</i> } <i>1 envelope</i></p> <p><i>Financial – 1 envelope</i> }</p> <p>Triplicate: <i>Technical – 1 envelope</i> } <i>1 envelope</i></p> <p><i>Financial – 1 envelope</i> }</p> <p style="text-align: right;"><i>Mother Envelope</i></p>

Resumption of Submission/Opening of Bids:

➤ Tuesday, 06 July 2021 – 9:30 AM

For guidance and information of all concerned.

Sgd.

MABEL R. CALVA, MPA
BAC Chairperson

Date: 23 June 2021

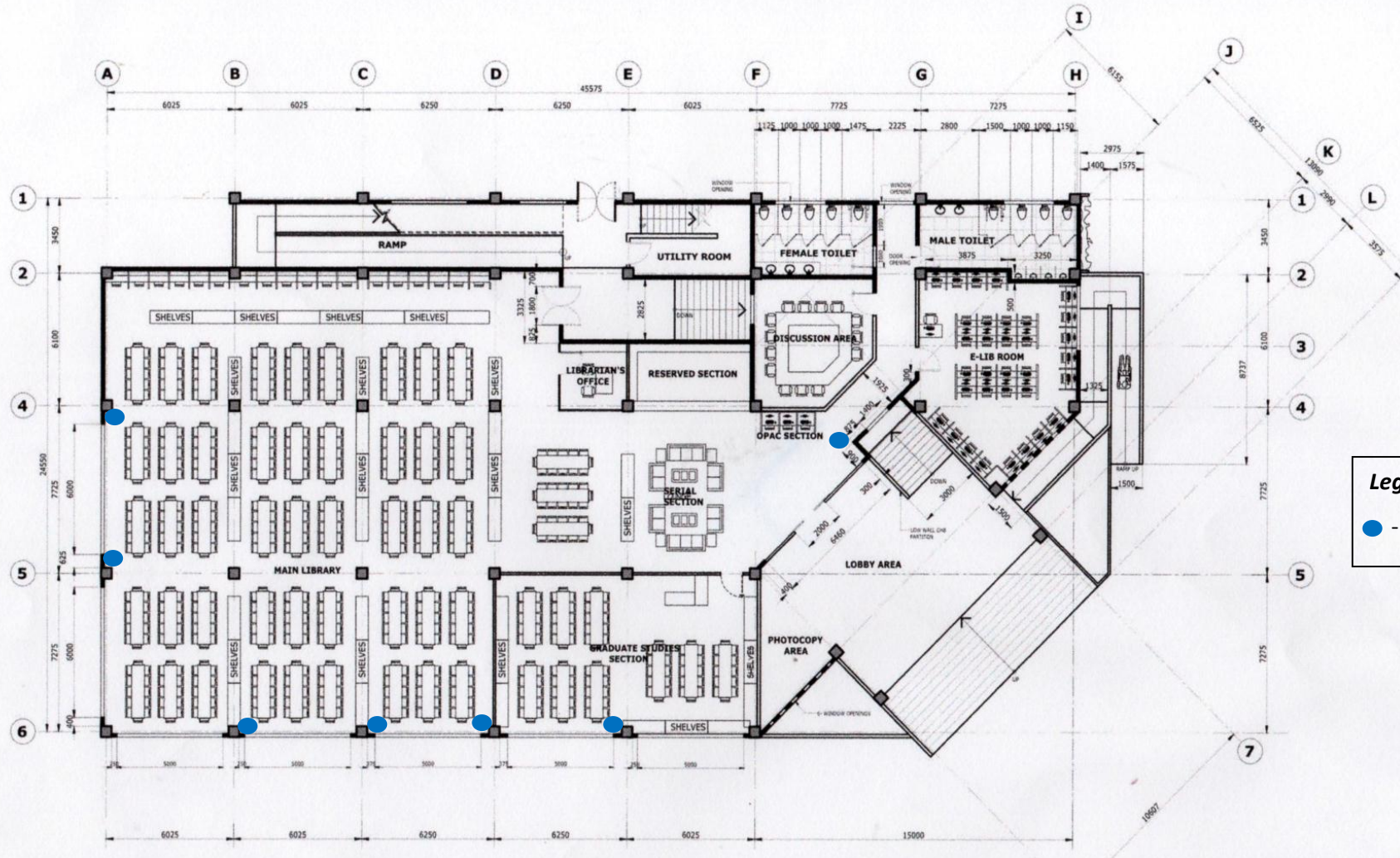

Legend:
 ● - 5TR ACU

GROUND FLOOR PLAN
 SCALE 1:200 N.043

Designer: RAYMART BULAG SAC Reg. Civil Engineer	ROBERTO P. PARAHAS Reg. Electrical Engineer	PROJECT TITLE: CONSTRUCTION OF TWO-STOREY UNIVERSITY LIBRARY BUILDING	OWNER: SOUTHERN LEYTE STATE UNIVERSITY	APPROVED AS PER: PROSE IVY G. YEYES, Ed.D. SLSU PRESIDENT	SHEET CONTENTS: AS SHOWN
NOTE: THESE DRAWINGS AND SPECIFICATIONS AND OTHER INFORMATION CONTAINED HEREIN SHALL BE THE SOLE RESPONSIBILITY OF THE DESIGNER AND CONTRACTOR. NO LIABILITY SHALL BE ASSUMED BY THE ARCHITECT FOR ANY DAMAGE TO PERSONS OR PROPERTY CAUSED BY ANY NEGLIGENCE OR MISFEASANCE OF ANY CONTRACTOR OR USER OF ANY INFORMATION CONTAINED HEREIN. THE ARCHITECT'S RESPONSIBILITY IS LIMITED TO THE DESIGN AND SPECIFICATIONS OF THE BUILDING AND ITS COMPONENTS. THE CONTRACTOR SHALL BE RESPONSIBLE FOR THE PROPER CONSTRUCTION AND MAINTENANCE OF THE BUILDING.		LOCATION: SLSU MAIN CAMPUS, SOGOD, SOUTHERN LEYTE	ADDRESS: SLSU MAIN CAMPUS, SOGOD, SOUTHERN LEYTE	ADDRESS: SLSU MAIN CAMPUS, SOGOD, SOUTHERN LEYTE	DRWG NO.: HS-087-SLSU-LIB-002